



M-1 DRILL RIG



Our Best Selling Core Rig

- ◆ 1" to 10" bit capacity (14" with one spacer)
- ◆ Dual switch/outlet control panel & amp meter
- ◆ Slide handle permits drilling in tight areas
- ◆ Streamlined base and carriage
- ◆ 2-1/2" square column with black oxidized finish
- ◆ Quick changeover from vacuum to anchor base
- ◆ 6" wheels for better mobility

Order Complete:

Our Combination rig includes a combination anchor/vacuum base, mast, carriage, control panel, vacuum pump, ceiling jack, motor mount plate and your choice of drill motor. Our Anchor rig is the same as above except for its smaller anchor base and does not include a vacuum pump. Select from P/N's listed below.

M-1 Complete Drill Rigs				
Motor	RPM	Safety Override	Combination Rig P/N	Anchor Rig P/N
20 Amp Core Bore	350/900	Slip Clutch	4245055	4545001
20 Amp Milwaukee	300/600	Slip Clutch	4245048	4245009
20 Amp Milwaukee	450/900	Slip Clutch	4245059	4245003
20 Amp Milwaukee	600/1200	Slip Clutch	4245049	4245010
15 Amp Milwaukee	500/1000	Slip Clutch	4245051	4245006
15 Amp Milwaukee	375/750	Slip Clutch	4245052	4245007
23 Amp Weka DK22	300/640/960	Slip Clutch	4245053	4245008
23 Amp Weka DK22S	420/880/1300	Slip Clutch	4245046	4245011

Or, Build Your Own:

Select one of the drill stands shown below, add drill motor, control panel/on-off switch, and vacuum pump as required for your application. Drill stands include a base, mast*, carriage, ceiling jack and motor mount plate.

* Call factory for special length masts

Combination Drill Stand Only *		Anchor Drill Stand Only *	
Standard P/N 4245065	Angle P/N 4245062	Standard P/N 4246055	Angle P/N 4246070

* Motor mount (part number 4648004) required if using a WEKA drill motor with M-1 combination or M-1 drill stand.



M-1 Complete Combination Rig
(20 Amp DeWalt - Part No. 4245055)

Location to drill anchor hole:
12" = M-1 Combo Rig; 12-1/2" = M-1 Anchor Rig
Measured from the center of the motor spindle to the center of the anchor/vacuum slot on the rig base.

M-1 Drill Stand Dimensions		
	Anchor Stand	Combination Stand
A.	43-3/4"	44-1/4"
B.	24-1/2"	24-1/2"
C.	5-5/8"	5-5/8"
D.	3-1/2" (square)	2-1/4" (square)
E. *	11"	17"
F.	16"	23"
G.	6" (width)	13-1/2" (width)
H.	23-1/2"	18-1/2"

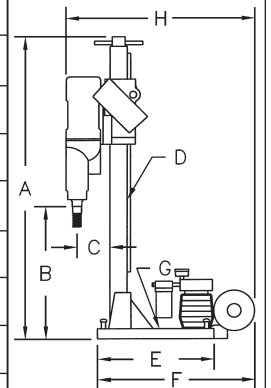

* For Core Bore motors

Core Rigs: M-1

